

Project :

Model # :

Item # :

Qty :

Approval :

Unit Cooler

Model : LED225BE(OX, NX, OM, NM)

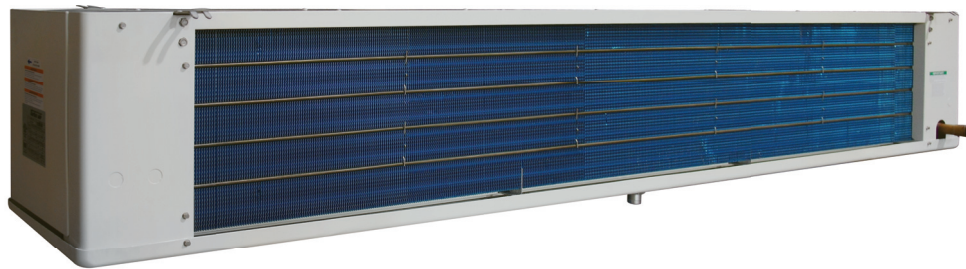

≡ FEATURES / BENEFITS ≡

- Blue anti-corrosion-fin increases the life span of the coil.
- Air-pass guard is located at the bottom of the coil to improve heat exchange rate.
- Easy to replace defrost heater (LED model).
- Corrugated fin is used to increase heat exchanges rate by expanding the surface area.
- Even in confined space, all parts can be reached easily by opening the front cover.
- Location of power connector makes replacement of motor convenient.
- Seamless inner groove copper tube increases the heat exchange rate by reducing the space between the fin and copper tube.
- Venturi type distributor and precise orifice hole are used to minimize the pressure drop and maximize the freezing capacity respectively.
- Even in confined space, all parts can be reached easily by opening the front cover.
- Thermostat is installed to prevent over temperature on heater.
- Circuit opens automatically over 70°F.
- Parts available:
Expansion Valve (Sporlan) (Factory Pre-mounted)
Solenoid Valve (Sporlan) (Factory Pre-mounted)
Thermostat (Johnson Control) (Shipped Loose)
- The spiral fan guard enables cold air to be delivered efficiently and thoroughly.
- The protruding fan and motor placement substantially reduce vibration and noise.
- EC Motor (Dual Speed) for high energy efficiency.
- Anti-oxidizing stainless steel mounting and bolts.

Unit Cooler

Model : LED225BE(OX, NX, OM, NM)

LED ELECTRIC DEFROST MODEL 60HZ WITH EC MOTOR (DUAL SPEED)

| Capacity (R-404A) | | | | Capacity (R-448A) | | | | Fan Data | | |
|------------------------------------|-------|------------------------------------|-------|------------------------------------|-------|------------------------------------|-------|----------|------|-----|
| 10°F / 6°C TD -20°F / -29°C SST | | 12°F / 7°C TD -22°F / -30°C SST | | 10°F / 6°C TD -20°F / -29°C SST | | 12°F / 7°C TD -22°F / -30°C SST | | CFM/m³H | | No. |
| BTUH | Watts | BTUH | Watts | BTUH | Watts | BTUH | Watts | | | |
| 22711 | 6651 | 26926 | 7886 | 22509 | 6592 | 26672 | 7812 | 3860 | 6559 | 5 |

| EC Motor Data | | | Defrost Heaters | | | Connections (Inches) | | | | Approx. Net Weight (Lbs. / Kg) | AWEF Value | |
|---------------|------------|-------|-----------------|------------|----------|----------------------|----------|-----------|---------|--------------------------------|------------|-----------------|
| 230V 1Ph 60Hz | | | Watts | Total Amps | | COIL INLET | SUCTION | EQUALIZER | DRAIN | | R-404A | R-448A / R-449A |
| HP | Total Amps | Watts | | 230/1/60 | 230/3/60 | | | | | | | |
| 1/25 | 2.25 | 125 | 4800 | 20.9 | 12.0 | 1/2 OD | 1-1/8 ID | 1/4 OD | 3/4 MPT | 116 / 52 | 4.15 | 4.15 |

Design and specifications subject to change without notice

LED225BEOX: R404A TXV "SBFSE-C-Z" (Inlet: 3/8", Outlet: 1/2") Pre-installed

LED225BENX: R448A/R449A TXV "SBFDE-B-Z" (Inlet: 3/8", Outlet: 1/2") Pre-installed

LED225BEO: R404A TXV "SBFSE-C-Z" (Inlet: 3/8", Outlet: 1/2") & LLSV "E5S130" (3/8") Pre-installed

LED225BENM: R448A/R449A TXV "SBFDE-B-Z" (Inlet: 3/8", Outlet: 1/2") & LLSV "E5S130" (3/8") Pre-installed

■ WARRANTY : 1 Year Fan Motor and Parts Warranty

PLAN VIEW

(unit : inch)

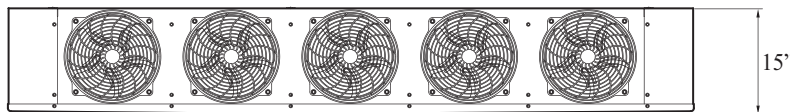

FRONT VIEW

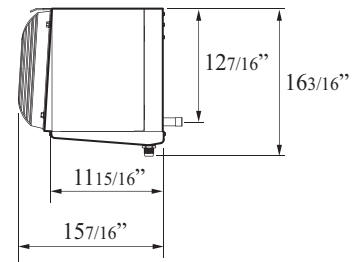

SIDE VIEW

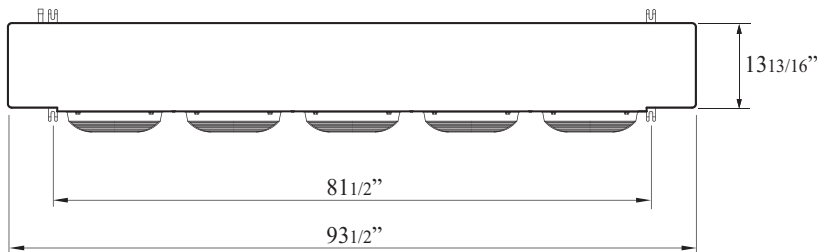

TOP VIEW



■ Toll Free: 888-900-1002



"Subject to change without notice" will allow Turbo Air to not be liable for small changes such as amperage, size or any other issue that someone would blame on us.